



FOR LEASING INFORMATION:
360.696.0873

CE JOHN

OVERVIEW

The Heights Shopping Center is located in one of the oldest and most well-established residential neighborhoods in Vancouver, Washington known as McLoughlin Heights. The Heights has been targeted for specialty retailers and service oriented businesses seeking well-established neighborhood locations in the Vancouver market.

The Heights Shopping Center is anchored by a 50k sq. ft. Safeway, which has incorporated its newest grocery concept with expanded product offerings including organic foods, in-store Starbucks, a wine area and prepared foods department. Additional tenants include Papa Murphy's and other local and regional tenants.

LOCATION E Mill Plain & Andresen
Vancouver, Washington 98661

SITE 84,000 square feet

DEMOGRAPHICS 5 MILES
Population 255,000+
Avg. HH Income \$63,000

TRAFFIC COUNTS	AVG DAILY TOTAL
E Mill Plain W of Andresen	20,490
E Mill Plain E of Andresen	25,952
Andresen S of E Mill Plain	10,198
Andresen N of E Mill Plain	21,926



THE HEIGHTS SHOPPING CENTER

6701 E MILL PLAIN, VANCOUVER, WA 98661

CE JOHN

SINCE 1947

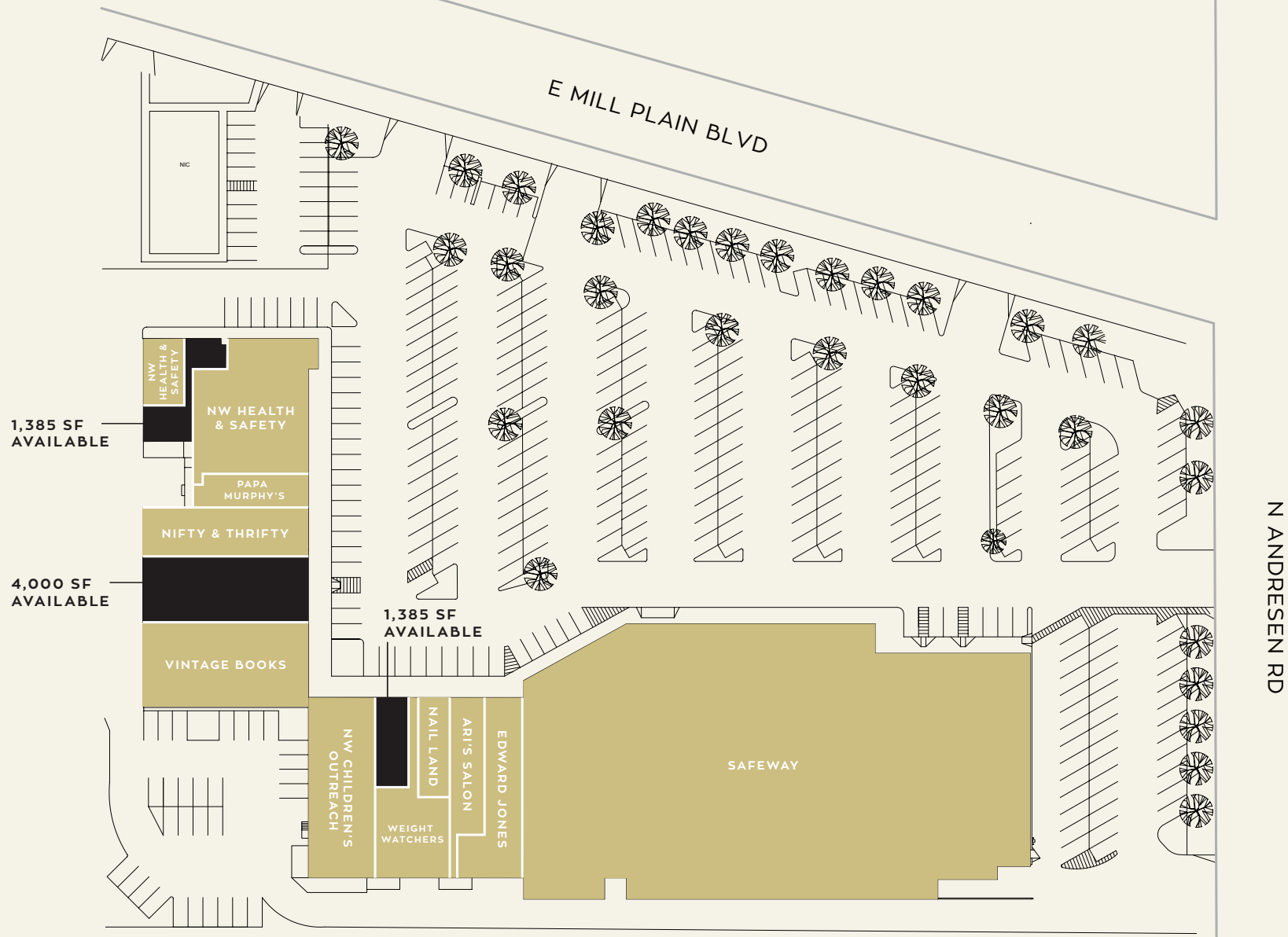

THE HEIGHTS SHOPPING CENTER

6701 E MILL PLAIN, VANCOUVER, WA 98661

CE JOHN

SINCE 1947



THE HEIGHTS SHOPPING CENTER

6701 E MILL PLAIN, VANCOUVER, WA 98661

CE JOHN

SINCE 1947

CE JOHN

SINCE 1947

THE HEIGHTS SHOPPING CENTER

6701 E MILL PLAIN
VANCOUVER, WA 98661